

## Explanation virtual tour MiCo

Go to <https://3dmap.micomilano.it>

Then you will see

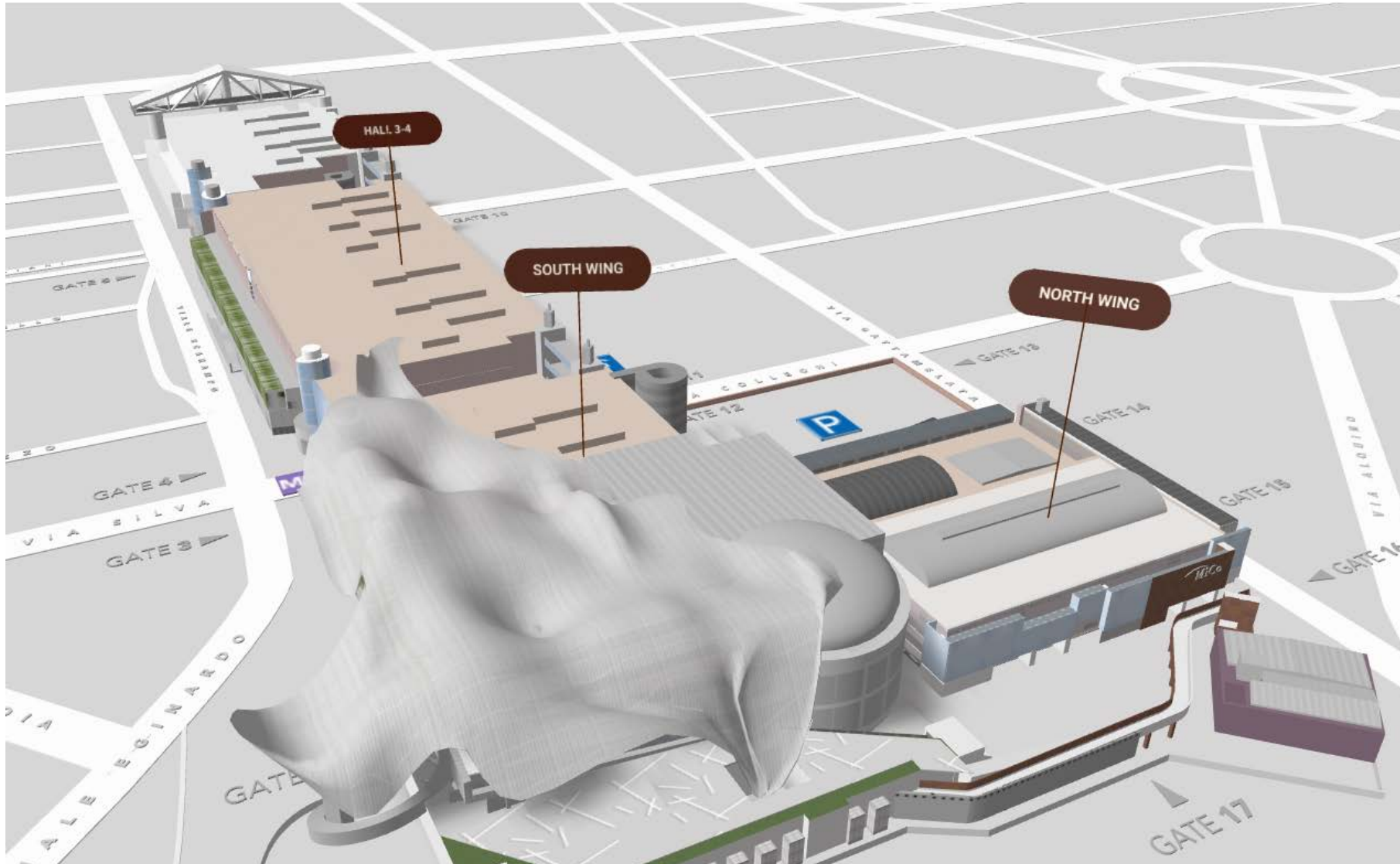

Then click on the menu in the right upper corner



Then click on Hall 3-4

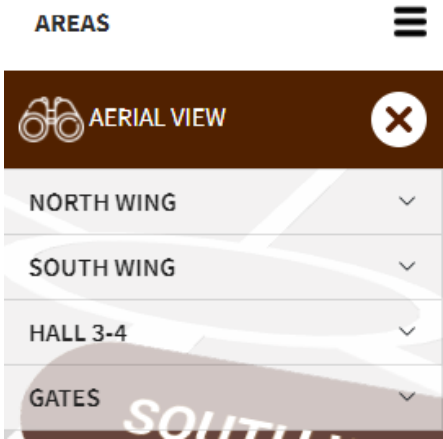

Then click on Level +2

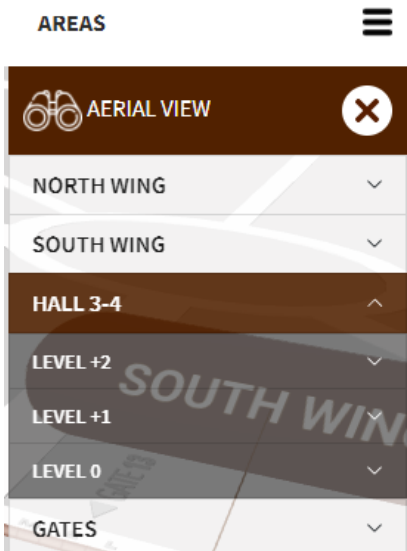

Then click on Hall 4

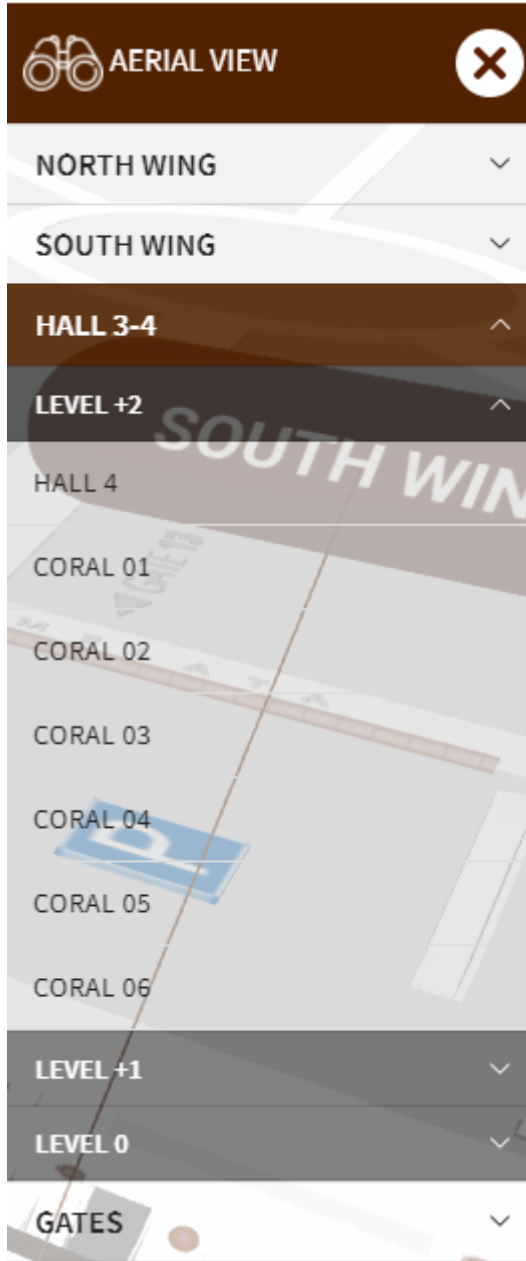

Then you will get see the following plan:



On your left side click on 360° PHOTO

The screenshot shows a mobile application interface for 'HALL 4'. At the top, there is a dark brown header with the text 'HALL 4' on the left and a white circular icon with a dark 'X' on the right. Below the header is a section titled 'DIMENSIONS AND CAPACITIES' in white text on a dark brown background, with a small white upward-pointing arrow on the right. The main content area is light gray and features a list of metrics, each followed by a slash: 'AREA: 16109 SQM | 173397,276 SQFT', 'HEIGHT M: /', 'WIDTH M: /', 'LENGTH M: /', 'THEATRE: /', 'THEATRE (COVID-19): /', 'CLASSROOM: /', 'O-SHAPE: /', 'U-SHAPE: /', 'BANQUET: /', and 'CABARET: /'. In the background, there is a faint architectural floor plan of a hall. At the bottom of the screen, there is a white bar with the text '360° PHOTO' on the left and a small dark downward-pointing arrow on the right.

Then you will see the following plan

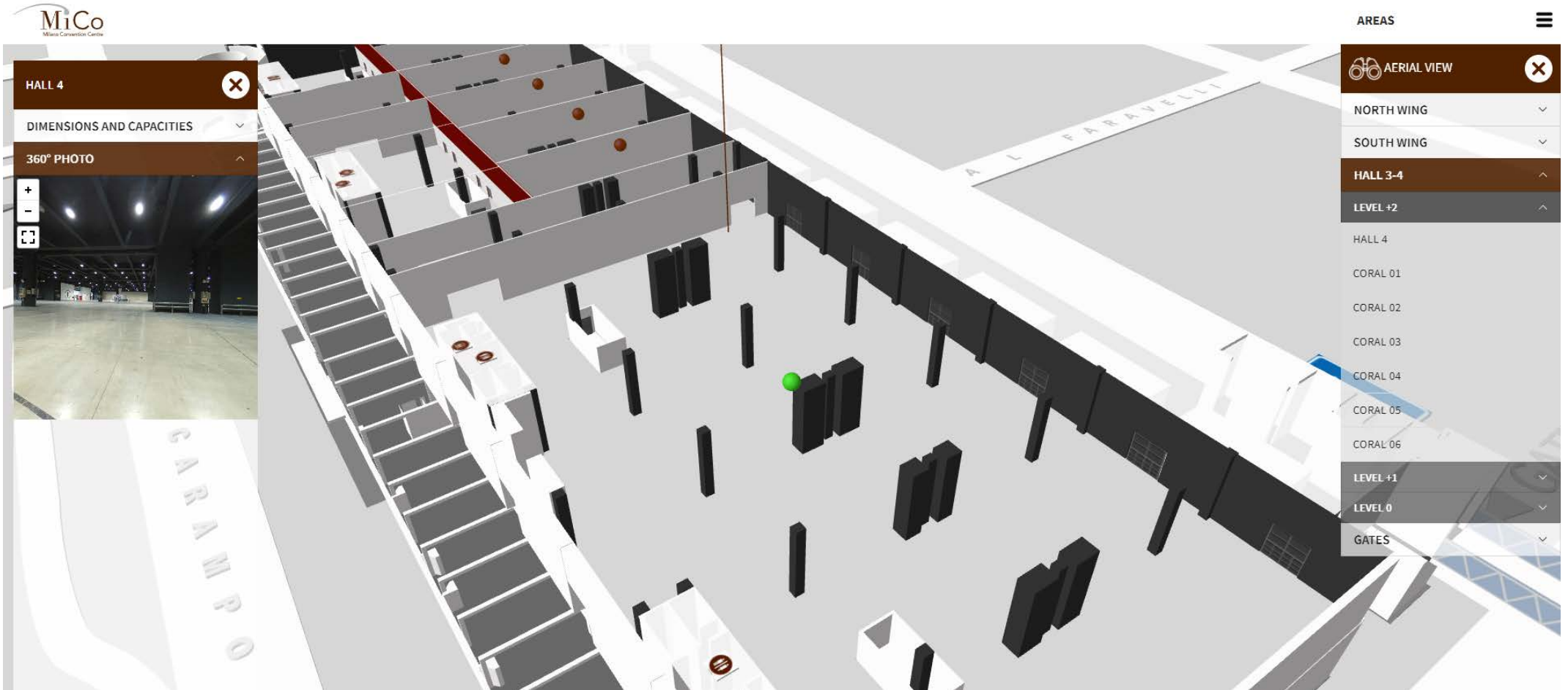

On your left side you will see

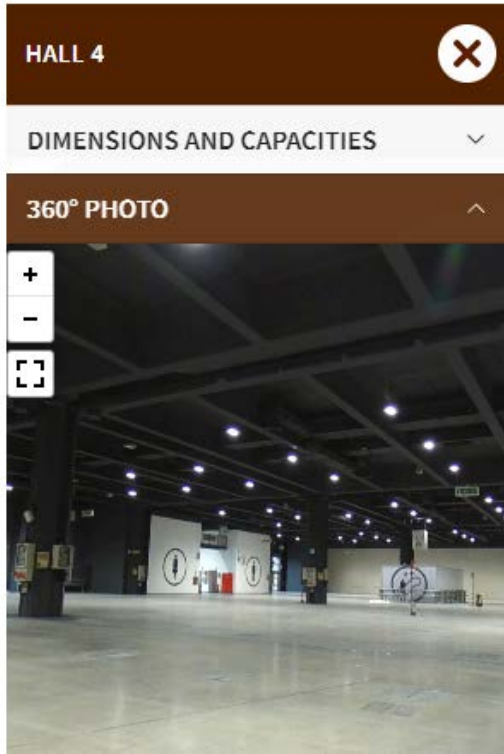

Click on the following symbol to go into the hall

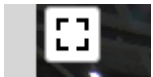

Keep in mind that the toilets are situated on your left side when entering Hall 4. Unfortunately you will not be able to see the entrance doors, which are lying behind the escalators.



When you enter the exhibit hall, then you will see the first escalator on your right side

